



Product Summary

The ZMS030N06P combines advanced trench MOSFET technology with a low resistance package to provide extremely low $R_{DS(ON)}$.

device constructure
 $R_{DS(ON)}$ to minimize conduction loss



Synchronous Rectification for AC-DC/DC-DC converter
 Oring switches
 Power Tools



<input type="checkbox"/> <input type="checkbox"/>	<input type="checkbox"/>
<input type="checkbox"/>	
<input type="checkbox"/> <input type="checkbox"/>	Bulk Tube
<input type="checkbox"/> <input type="checkbox"/> <input type="checkbox"/> <input type="checkbox"/>	500

$T_C = 25$

Parameter	Symbol	Rating	Unit
Drain-Source Voltage	V_{DS}	60	V
Gate-Source Voltage	V_{GS}	± 20	V
Continuous Drain Current	$I_{D@TC=25}$	150	A
	$I_{D@TC=75}$	114	A
	$I_{D@TC=100}$	94.5	A
Pulsed Drain Current	I_{DM}	400	A
Total Power Dissipation($TC=25$)	$P_D@TC=25$	150	W
Operating Junction Temperature	T_J	-55 to 150	
Storage Temperature	T_{STG}	-55 to 150	
Single Pulse Avalanche Energy@ $L=0.1mH$	E_{AS}	180	mJ
Avalanche Current@ $L=0.1mH$	I_{AS}	60	A

Thermal resistance







Dimensions (TO-220)

Unit mm

	2..		2
	0.		.			0 2	
	..		2.		.		2
	.		..		0 .		2 .
	. 1		.		1..	1 .	2..
	..		.		0 .		1..
	.		.		0..		1..
					1 .		1 .

□

□

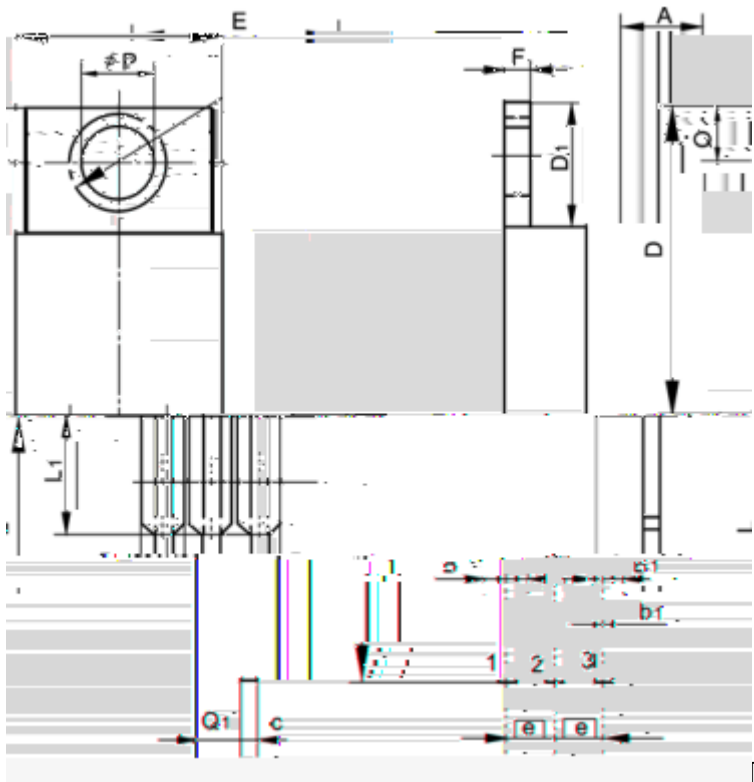

□

□